

Intelligent Integration IR PTZ Camera

**MKB01 or MKB03 (Recommended Keyboard Controller)**

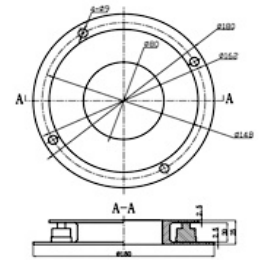

Dimension (Unit: mm)

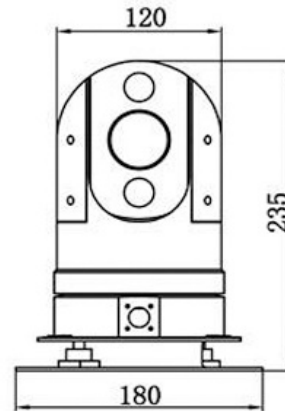

Accessories (Optional)



**Features:**

- PTZ has three installation ways
- The bottom shock absorber, match the car cloud stand, install on the top of car
- The bottom magnet, placed on a tripod for field survey use, can also be used for video conferencing
- Bottom strong disk, no need to install the car in the roof bracket, direct strong adsorption on the top of the car, easy installation and destruction
- The system is a set of high-definition video wireless transmission, voice cluster talkback, car hard disk video, GPS / Beidou dual-mode positioning, WIFI hotspot transmission, local monitoring, PTZ control and other components. Of all-round, multi-functional vehicle control center.
- Night Vision Supplement: The use of imported OSRAM high-brightness light-emitting infrared light, night vision is **50-80** meters
- HD IP: PTZ support mainstream megapixel digital high-definition movement and HD SENSOR HD picture capture, compatible with mainstream HD platform and seamless docking, the maximum support 1080P output, support for dual-stream and high-definition capture, support IE browser

## Specification

<b>Camera</b>	Camera	2.0 Mega Pixel Camera Module
	Image sensor	1/3" Progressive CMOS
	Effective Pixels	1920x1080
	Optical Zoom	<b>20x</b> , 5.4-108mm
	Aperature	F1.5-F2.7
	Angle of View	Horizontal: 50.2° -2.9° (Wide-Tele), Vertical: 37.9° -2.1°
	S/N ratio	>52dB
	Day / Night	IR-CUT, Auto, Color, B/W
	MOD	10mm~1500mm (Wide~Tele)
	Zoom Speed	3 Sec. (Optical, Wide~Tele)
<b>PTZ</b>	Pan/Tilt Range	Pan:360° endless ,Tilt:+90° ~ -20°
	Pan/Tilt Preset Speed	<b>Pan:300° /s ,Tilt:120° /s</b>
	Pan/Tilt Control Speed	Pan:0° -220° /s ,Tilt:0° -90° /s
	Preset Positions	255 presets ,6 cruising tracks
	Communications	RS485, Built-in 16 protocol, Baud Rate from 2400Bps to 19200Bps optional
<b>Network</b>	Video Compression	H.264/H.265
	Audio Compression	G.722.1、G.711-alaw、G.711-ulaw、MP2L2、G.726
	Compression output rate	32Kbps—16Mbps
	Support Protocol	TCP/IP、HTTP、DHCP、DNS、DDNS、RTP、RTSP、PPPoE、SMTP、NTP、UPnP、SNMP、FTP、802.1x、QoS、HTTPS、IPv6 (SIP、SRTP optional)、GB28181
	Interface Protocol	ONVIF/PSIA/CGI/ISAPI
	Communication Protocol	PelcoD-P Protocol
	Storage Function	Support MicroSD storage
	Intelligent Arlarm	Motion detection, mask alarm, full memory, memory mistake
	While previewing video	Most 10 Channels
	User Rights	At most 32 users, with three grades: Administrator, Operator, and ordinary users can only view
	Safe Mode	Authorized user name and password, and MAC address binding; HTTPS encryption; IEEE 802.1x network access control, IP address filtering
	ROI Code	Support 24pcs, Grade can be adjusted
	<b>General</b>	Work temperature
Power		<b>DC10.8v-DC18v</b>
IP Grade		IP66
Impact resistance requirement		≥4G
Weight		2.5kg

